

Incremental Type RI-16 (Shaft) / RI-64 (Hollow Shaft), High Resolution

High rotational speed	High IP	Temperature -20 to 80 °C	High shaft load capacity	Shock/vibration resistant	Magnetic field proof	Short-circuit protected	Optical sensor

High Performance

- High shaft loading capability
- Maximum speed up to 12000 revolutions per minute
- High IP protection up to max. IP66



Many Variants

- With RS422 or push-pull interface
- With cable or connector

Compact

- Ø 58 mm housing, industry standard

Mechanical Characteristics:

Speed:	Shaft IP65 Hollow Shaft IP40 Hollow Shaft IP66 ¹⁾	12000 RPM 12000 RPM 6000 RPM
Moment of inertia:	Shaft version Hollow shaft version	approx. 0.098 oz-in ² (1.8 x 10 ⁻⁶ kgm ²) approx. 0.328 oz-in ² (6 x 10 ⁻⁶ kgm ²)
Starting torque at 68 °F (20 °C):		<1.4oz-in (0.01 Nm), IP40/IP65 <7oz-in (0.05 Nm), IP66
Radial load capacity of the shaft:		18 lbs (80 N)
Axial load capacity of the shaft:		9 lbs (40 N)
Weight:		approx. 0.9 lbs (0.4 kg)
Protection acc. to EN 60529 :		IP40, IP65, IP66
Working temperature:		-4 to +221 °F (-20 to +105 °C), IP40/IP65 -4 to +194 °F (-20 to +90 °C), IP66
Materials:	Shaft/hollow shaft	stainless steel
Shock resistance acc. to EN 60068-2-27:		approx. 100 g (1000 m/s ²), 6 ms
Vibration resistance acc. to EN 60068-2-27:		approx. 10 g (100 m/s ²), 10-2000 Hz

¹⁾ For continuous operation max 3000 RPM, ventilated

Rotary Position Technology

Incremental Encoders

Incremental Type RI-16 (Shaft) / RI-64 (Hollow Shaft), High Resolution

Electrical Characteristics:

Output circuit [Key Code]:	RS 422 [4A/4C] (TTL compatible)	Push-Pull [2B]
Supply voltage:	5 VDC ($\pm 5\%$) or 10-30 VDC	10-30 VDC
Power consumption (no load):	typ. 70 mA / max. 120 mA	typ. 115 mA / max. 160 mA
Permissible load/channel:	max. ± 20 mA	max. ± 30 mA
Pulse frequency:	max. 800 kHz	max. 600 kHz
Signal level high:	min. 2.5 V	min. +V -2.5 V
Signal level low:	max. 0.5 V	max. 2.0 V
Rise time t_r :	max. 200 ns	max. 1 μ s
Fall time t_f :	max. 200 ns	max. 1 μ s
Short-circuit protected:	yes ¹⁾	yes
Reverse polarity protection:	5 VDC: No, 10-30 VDC: yes	yes
UL approval:	file E356899	
RoHS compliant acc. to EU guideline 2011/65/EU		

¹⁾ Only one channel allowed to be shorted-out: (If +V = 5 V, short-circuit to channel, 0 V, or +V is permitted) (If +V = 10-30 V, short-circuit to channel or 0 V is permitted)

Standard Wiring:

Connection Type	Case Ground	Common (0 V)	+V	A	\bar{A}	B	\bar{B}	Z	\bar{Z}	-	-	Com / Sensor	+V Sensor
M23 Multifast	Coupling Nut	10	12	5	6	8	1	3	4	-	-	11	2
M12 Eurofast	Coupling Nut	1	2	3	4	5	6	7	8	-	-	-	-
Cable	Shield/Drain	WH	BN	GN	YE	GY	PK	BU	RD	BK	VT	GY/PK	RD/BU

Wiring Diagrams:

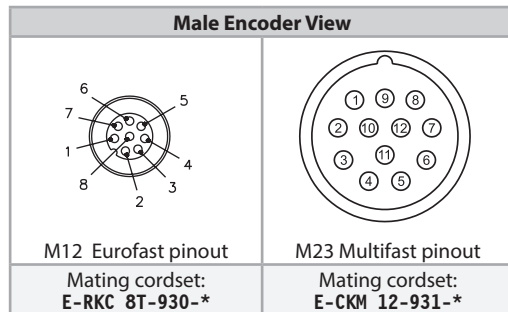

* Length in meters.

Incremental Type RI-16 (Shaft) / RI-64 (Hollow Shaft), High Resolution

Part Number Key: RI-16 Shaft Version

A	B	C		D	E		F
RI-16T	6	C	-	2B	6000	-	H1181

A	Type
RI-16T	Ø 58 mm, Shaft w/ Flat, IP65 Shaft Seal

B	Shaft (Ø x L)
6	Ø 6 mm x 10 mm
10	Ø 10 mm x 20 mm

C	Flange
C	Ø 58 mm Clamping Flange
S	Ø 58 mm Servo Flange

D	Voltage Supply and Output Type
2B	10-30 VDC, Push-Pull (w/ Inverted Signals)
4A	5 VDC, RS422 (w/ Inverted Signals)
4C	10-30 VDC, RS422 (w/ Inverted Signals)

E	Pulse Rate
	6000, 7200, 8000, 8192, 9000, 10000, 18000, 36000 Other Pulse Rates Available on Request

F	Type of Connection
H1181	Radial 8-pin M12 Eurofast Connector
H1481	Axial 8-pin M12 Eurofast Connector
12M23	Radial 12-pin M23 Multifast Connector
12M23A	Axial 12-pin M23 Multifast Connector
C1M	Radial Cable (1 m PUR)
CA1M	Axial Cable (1 m PUR)

Part Number Key: RI-64 Hollow Shaft Version

A	B	C		D	E		F
RI-64B	6	T	-	2B	6000	-	H1181

A	Type
RI-64B	Ø 58 mm, Blind Hollow Shaft, IP66 Shaft Seal
RI-64C	Ø 58 mm, Blind Hollow Shaft, IP40 Shaft Seal
RI-64H	Ø 58 mm, Hollow Shaft, IP66 Shaft Seal
RI-64I	Ø 58 mm, Hollow Shaft, IP40 Shaft Seal

B	Bore (30 mm max insertion depth for blind hollow shaft)
6	Ø 6 mm
8	Ø 8 mm
10	Ø 10 mm
12	Ø 12 mm

C	Flange
T	Ø 58 mm Flange w/ Torque Stop
E1	Ø 65 mm Flange w/ Flex Mount

D	Voltage Supply and Output Type
2B	10-30 VDC, Push-Pull (w/ Inverted Signals)
4A	5 VDC, RS422 (w/ Inverted Signals)
4C	10-30 VDC, RS422 (w/ Inverted Signals)

E	Pulse Rate
	6000, 7200, 8000, 8192, 9000, 10000, 18000, 36000 Other Pulse Rates Available on Request

F	Type of Connection
H1181	Radial 8-pin M12 Eurofast Connector
12M23	Radial 12-pin M23 Multifast Connector
C1M	Radial Cable (1 m PVC)

Accessories:

- See page H1, Connectivity, for cables and connectors
- See page G1, Accessories, for mounting attachments and couplings

Rotary Position Technology

Incremental Encoders

Incremental Type RI-16 (Shaft) / RI-64 (Hollow Shaft), High Resolution

Dimensions: RI-16 Shaft Version

RI-16 Flange C Connection 12M23 & 12M23A

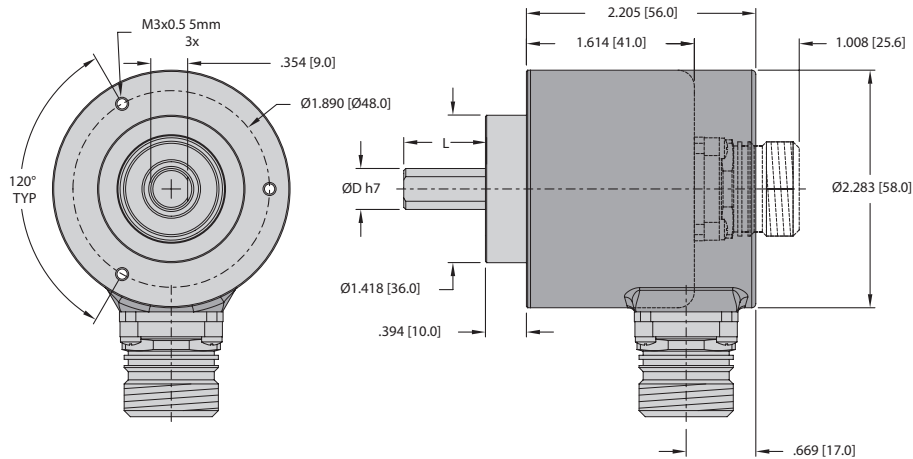

RI-16 Flange S Connection C1M & CA1M

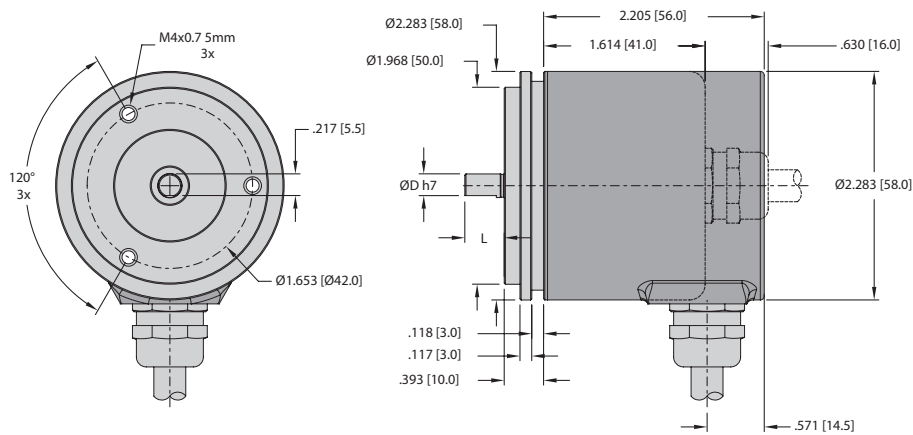

Mounting advice:

The flanges and shafts of the encoder and drive should not be rigidly coupled together at the same time. We recommend the use of suitable couplings (see page G1, Accessories).

Incremental Type RI-16 (Shaft) / RI-64 (Hollow Shaft), High Resolution

Dimensions: RI-64 Hollow Shaft Version

RI-64 Flange T Connection C

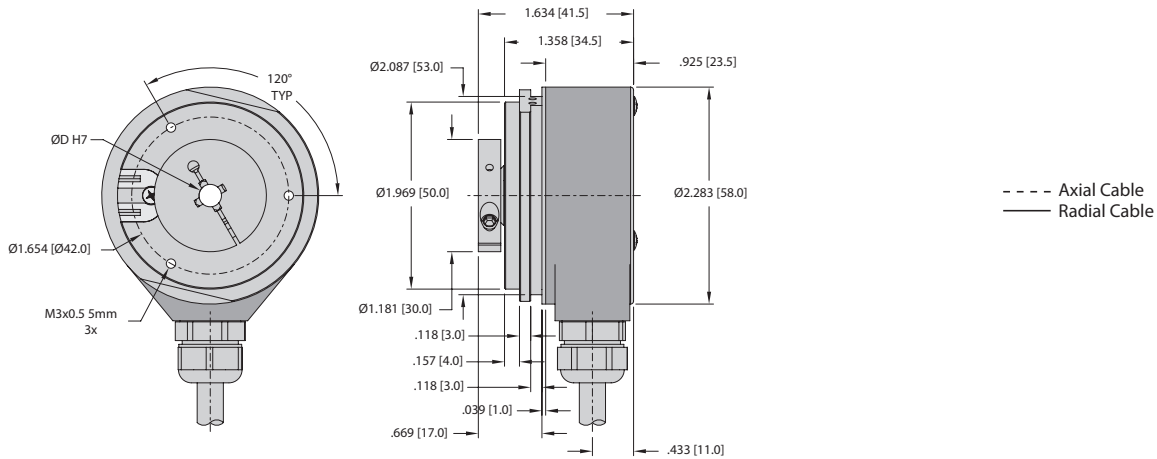

RI-64 Flange E1 Connection 12M23

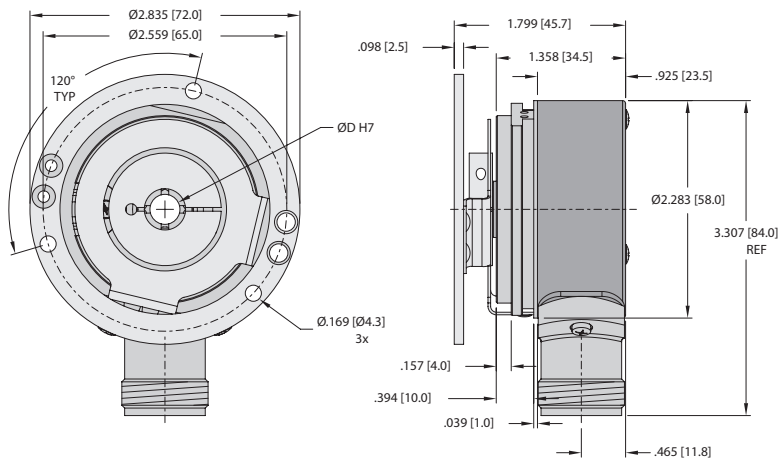

Mounting advice:

The flanges and shafts of the encoder and drive should not be rigidly coupled together at the same time. We recommend the use of suitable couplings (see page G1, Accessories).