

C31

3 pole | changeover contact | plug-in



Maximum contact load	10 A / 250 V AC-1
	10 A / 30 V DC-1
Recommended minimum contact load	50 mA / 10 V

Contacts

Material	⚡ AgCuNi
Rated operational current	10 A
Max. inrush current (20 ms)	40 A
Rated switching voltage	250 V
Max. AC load	2500 VA AC-1
Max. DC load 30V / 230V DC-1 (Fig. 2)	300W / 90 W

Coils (Values are valid at 20 °C)

Pick-up voltage	$\leq 0.8 \times U_N$
Release voltage AC / DC	$> 0.15 \times U_N / > 0.05 \times U_N$
Nominal power AC / DC	2.5 VA / 1.2 W

Coil Table

V_N AC	Ω	mA	V_N DC	Ω	mA
24	52	104	12	115	104
48	240	55	24	480	50
115	1350	23	48	1850	26
230	5600	11.5	110	9000	12
			220	29000	7.6

Types with LED indicator take additional 5 ... 10 mA @ < 80 V

Insulation

Contact Open	1.5 kV rms / 1 min
Contact Contact	1.5 kV rms / 1 min
Contact Coil	2 kV rms / 1 min

Specifications

Ambient temperature operation, storage	-40 ... +70 °C (no ice)
Pickup time AC / DC	3 ... 10 ms / ≤ 12 ms
Release time AC / DC	2 ... 15 ms / ≤ 3.5 ms
Bounce time NO contact AC / DC	3 ... 6 ms / approx. 3.5 ms
Mechanical life	$\geq 100\ 000\ 000$ operations
Operating frequency at nominal load	≤ 360 operations / h
Weight	80 g

Product References

AC 50 Hz / 60 Hz: 24, 48, 115, 230 (240)	C31/AC...V
LED	C31L/AC...V
DC: 12, 24, 48, 110, 220	C31/DC...V
Free wheeling diode	C31D/DC...V
LED + Free wheeling diode	C31DL/DC...V
Railway EN 50155	C31D/R DC...V

"..." List Coil Voltage to complete Product References

Accessories

Socket:	S3-B, S3-S, S3-L, S3-PO, S3-MB0, S3-MB1
Blanking Plug:	SO-NP (BAG 10 PCS)



Connection diagram

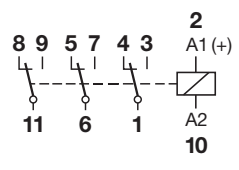

Fig.1 AC voltage endurance

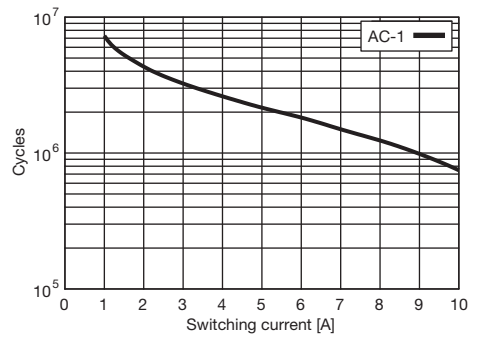
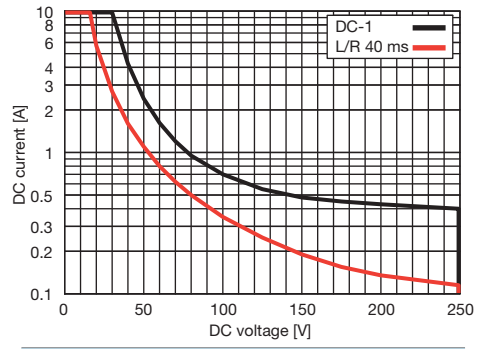
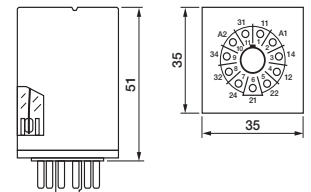

Fig. 2 DC load limit curve



Dimensions



Technical approvals, conformities

IEC/EN 61810; IEC/EN 60947; IEC/EN 50155
 IEC/EN 61373; IEC/EN 45545
 NF F 16-101/102