

REM-E-121T10C-9F32B-H1151

Absolute Rotary Encoder - Multiturn

Efficiency Line

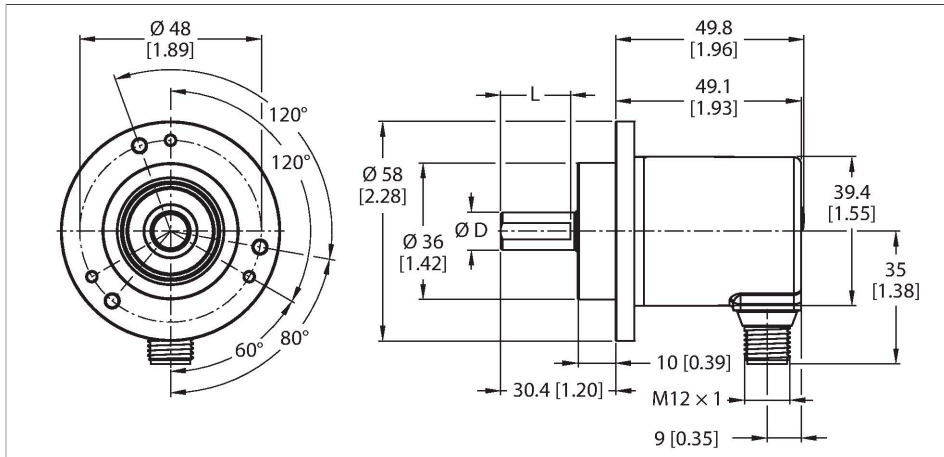

Features

- Ø 58 mm clamping flange
- Solid shaft, Ø 10mm x 20mm
- Optical measuring principle
- Shaft material, stainless steel
- Protection class IP64 on housing and shaft side
- -20...+70 °C
- Max. 4000 rpm (continuous operation 2000 rpm)
- Energy harvesting technology
- 10-30 VDC
- SAE J1939
- M12 connection, 5-pin
- Singleturn resolution 14 bit scalable, default 14 bit
- Multiturn resolution scalable up to 29 bit over total resolution, default 18 bit
- Total resolution 32 bit scalable, default: 32 bit

Technical data

Type	REM-E-121T10C-9F32B-H1151
ID	100023364
Measuring principle	Magnetic
General data	
Max. rotational speed	4000 rpm
Repetition accuracy	± 0.2 ° At 25 °C
Absolute accuracy	± 1 ° At 25 °C
Output type	Absolute multiturn
Electrical data	
Operating voltage U _B	10...30 VDC
No-load current	≤ 80 mA
Short-circuit protection	yes
Wire break/reverse polarity protection	yes
Communication protocol	SAE J1939
Interface	SAE J1939
Mechanical data	
Flange type	Clamping flange
Flange diameter	Ø 58 mm
Shaft Type	Solid shaft
Shaft diameter D (mm)	10
Shaft Length L [mm]	20
Shaft material	Stainless Steel
Housing material	Die-cast zinc

Wiring diagram

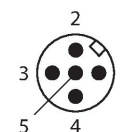
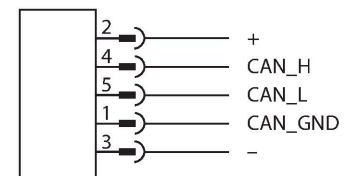

Technical data

Electrical connection	Connector, M12 × 1
	M12, 5-pole
Axial shaft load	40 N
Radial shaft load	80 N
Environmental conditions	
Ambient temperature	-20...+70 °C
Vibration resistance (EN 60068-2-6)	30 g (300 m/s ²), 10...2000 Hz
Shock resistance (EN 60068-2-27)	500 g (2500 m/s ²), 4 ms
Protection class	IP64
Protection class shaft	IP64

Accessories

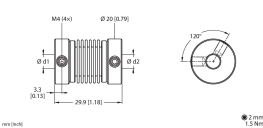
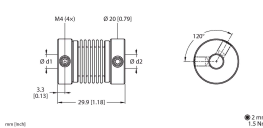
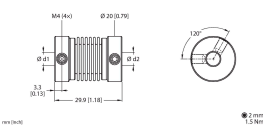
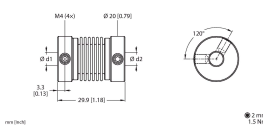
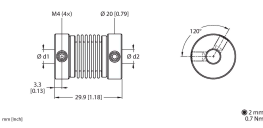
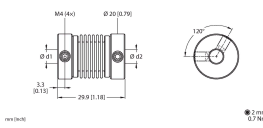
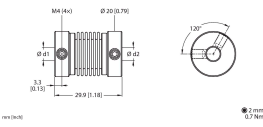
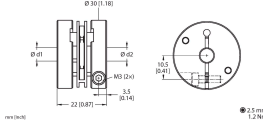
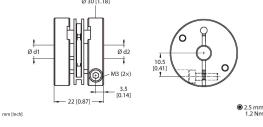
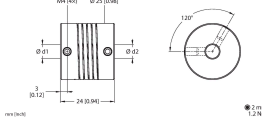
<p>RA-BC-20-06-10 100048779</p>  <p>Bellows coupling with aluminum hub Ø 20 mm; d1 = 6 mm, d2 = 10 mm</p>	<p>RA-BC-20-08-10 100048781</p>  <p>Bellows coupling with aluminum hub Ø 20 mm; d1 = 8 mm, d2 = 10 mm</p>
<p>RA-BC-20-10-10 100048782</p>  <p>Bellows coupling with aluminum hub Ø 20 mm; d1 = 10 mm, d2 = 10 mm</p>	<p>RA-BC-20-10-12 100048783</p>  <p>Bellows coupling with aluminum hub Ø 20 mm; d1 = 10 mm, d2 = 12 mm</p>
<p>RA-BC-E-20-06-10 100048786</p>  <p>Stainless steel bellows coupling Ø 20 mm; d1 = 6 mm, d2 = 10 mm</p>	<p>RA-BC-E-20-10-10 100048787</p>  <p>Stainless steel bellows coupling Ø 20 mm; d1 = 10 mm, d2 = 10 mm</p>
<p>RA-BC-E-20-10-12 100048788</p>  <p>Stainless steel bellows coupling Ø 20 mm; d1 = 10 mm, d2 = 12 mm</p>	<p>RA-SDC-30-10-10 100048792</p>  <p>Spring disc coupling Ø 30 mm; d1 = 10 mm, d2 = 10 mm</p>
<p>RA-SDC-30-10-12 100048793</p>  <p>Spring disc coupling Ø 30 mm; d1 = 10 mm, d2 = 12 mm</p>	<p>RA-HC-25-10-10 100048796</p>  <p>Aluminum helix coupling Ø 25 mm; d1 = 10 mm, d2 = 10 mm</p>

RA-HC-25-10-12

100048797

Aluminum helix coupling \varnothing 25 mm; d1 = 10 mm, d2 = 12 mm

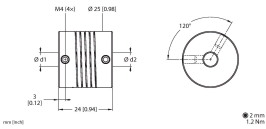

Wiring accessories

Dimension drawing

Type

ID

RKC5701-5M

6931034

Bus cable for CAN (DeviceNet, - CANopen), M12 female connector, straight, cable length: 5 m, jacket material: PUR, anthracite; cULus approval

