

RES-184S6C-9F14B-H1151

Absolute Rotary Encoder - Singleturn

Industrial Line

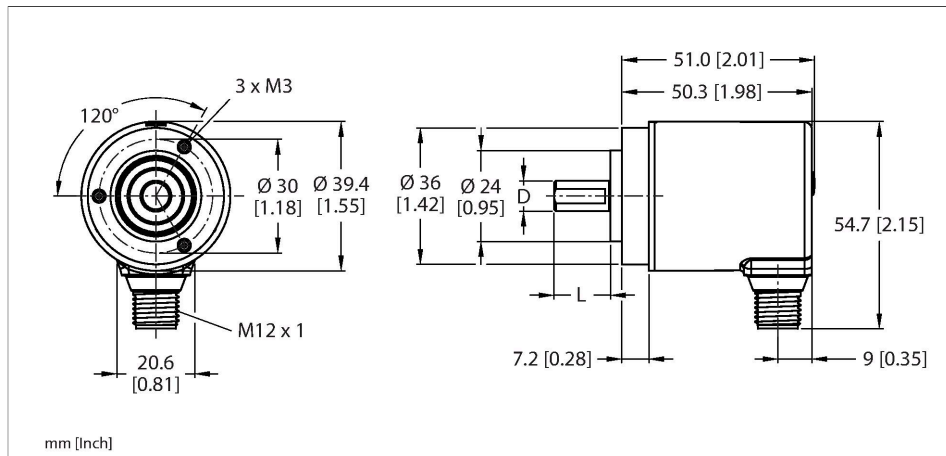

Technical data

Type	RES-184S6C-9F14B-H1151
ID	100026153
Measuring principle	Magnetic
General data	
Max. rotational speed	4000 rpm
Starting torque	< 0.01 Nm
Measuring range	0...360 °
Absolute accuracy	± 0.015 ° At 25 °C
Output type	Absolute singleturn
Resolution singleturn	14 Bit
Electrical data	
Operating voltage U_b	10...30 VDC
No-load current	≤ 80 mA
Short-circuit protection	yes
Wire break/reverse polarity protection	yes
Communication protocol	SAE J1939
Interface	SAE J1939
Mechanical data	
Flange type	Clamping flange
Flange diameter	Ø 36 mm
Shaft Type	Solid shaft
Shaft diameter D (mm)	6
Shaft Length L [mm]	12.5

Features

- Clamping flange, Ø 36 mm
- Solid shaft, Ø 6 mm × 12.5 mm
- Magnetic measuring principle
- Shaft material: stainless steel
- IP67 rated on the shaft side
- -40...+85 °C
- Max. 4000 rev/min
- 10...30 VDC
- SAE J1939
- M12 × 1 male, 5-pin
- 360° resolved in 14 bit (16384 positions)

Wiring diagram

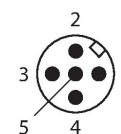
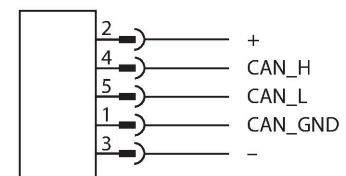

Technical data

Shaft material	Stainless steel
Housing material	Die-cast zinc
Electrical connection	Connector, M12 × 1
Axial shaft load	20 N
Radial shaft load	40 N
Environmental conditions	
Ambient temperature	-40...+85 °C
Vibration resistance (EN 60068-2-6)	300 m/s ² , 10...2000 Hz
Shock resistance (EN 60068-2-27)	2500 m/s ² , 6 ms
Protection class	IP67
Protection class shaft	IP67

Accessories

RCS-15-08-06 1545361

Bellows coupling, outer diameter:
15 mm, bore diameter: 8 mm/6 mm

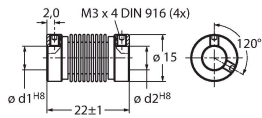

RCS-15-06-06 1545362

Bellows coupling, outer diameter:
15 mm, bore diameter: 6 mm/6 mm

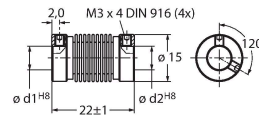

RA-BC-20-06-06 100048777

Bellows coupling with aluminum hub
Ø 20 mm; d1 = 6 mm, d2 = 6 mm

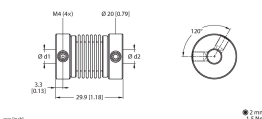

RA-BC-20-06-08 100048778

Bellows coupling with aluminum hub
Ø 20 mm; d1 = 6 mm, d2 = 8 mm

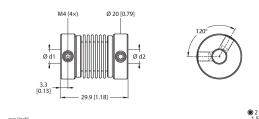

RA-BC-20-06-10 100048779

Bellows coupling with aluminum hub
Ø 20 mm; d1 = 6 mm, d2 = 10 mm

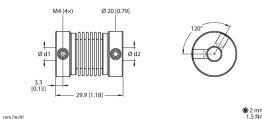

RA-BC-E-20-06-06 100048785

Stainless steel bellows coupling
Ø 20 mm; d1 = 6 mm, d2 = 6 mm

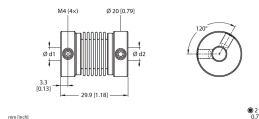

RA-BC-E-20-06-10 100048786

Stainless steel bellows coupling
Ø 20 mm; d1 = 6 mm, d2 = 10 mm

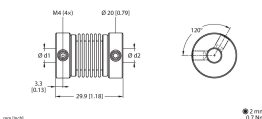

RA-SDC-30-06-10 100048791

Spring disc coupling Ø 30 mm; d1 =
6 mm, d2 = 10 mm

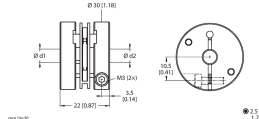

RA-SDC-30-06-06 100048790

Spring disc coupling Ø 30 mm; d1 =
6 mm, d2 = 6 mm

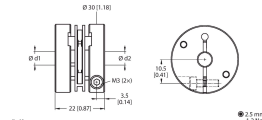

RA-HC-25-06-06 100048794

Aluminum helix coupling Ø 25 mm; d1 =
6 mm, d2 = 6 mm

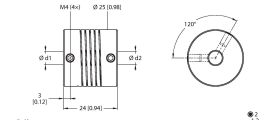

RA-HC-25-06-10

100048795

Aluminum helix coupling \varnothing 25 mm; d1 = 6 mm, d2 = 10 mm

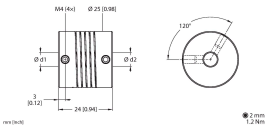

Wiring accessories

Dimension drawing

Type

ID

RKC5701-5M

6931034

Bus cable for CAN (DeviceNet, - CANopen), M12 female connector, straight, cable length: 5 m, jacket material: PUR, anthracite; cULus approval

