

RI-12I14E-4B4096-H1181 Incremental Encoder Industrial Line

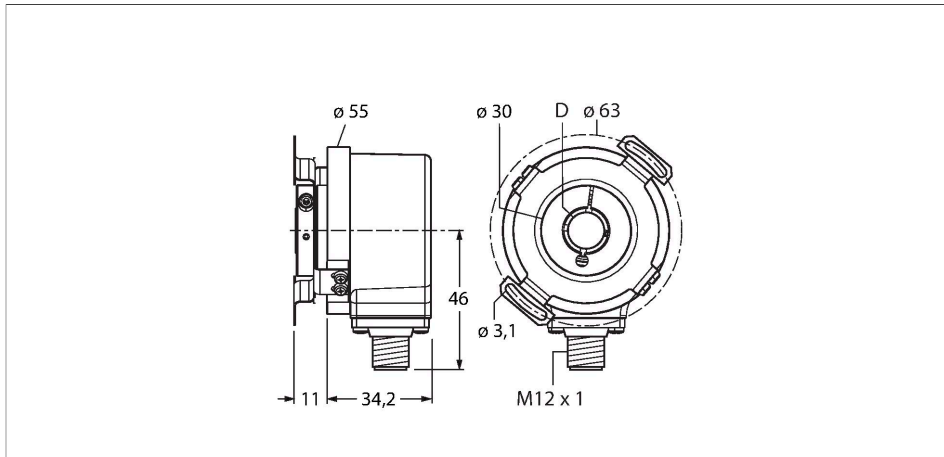

Technical data

Type	RI-12I14E-4B4096-H1181
ID	1545301
Measuring principle	Optical
General data	
Max. rotational speed	12,000 rpm
Moment of inertia of the rotor	$6 \times 10^{-6} \text{ kgm}^2$
Starting torque	< 0.05 Nm
Output type	Incremental
Resolution incremental	4096 ppr
Electrical data	
Operating voltage U_B	5...30 VDC
No-load current	$\leq 90 \text{ mA}$
Output current	$\leq 20 \text{ mA}$
Short-circuit protection	yes
Wire break/reverse polarity protection	yes
Pulse frequency max.	300 kHz
Signal level high	min. 2.5 V
Signal level low	max. 0.5 V
Output function	RS422/TTL, with inverted signals
Mechanical data	
Flange type	Flange with stator coupling
Flange diameter	$\varnothing 63 \text{ mm}$
Shaft Type	Hollow shaft

Features

- Flange with slotted flex mount, $\varnothing 63 \text{ mm}$
- Hollow shaft, $\varnothing 14 \text{ mm}$
- Optical measuring principle
- Shaft material: stainless steel
- Protection class IP65 on shaft side
- $-40 \dots +85 \text{ }^\circ\text{C}$
- Max. 12000 rpm (continuous operation 6000)
- 5...30 VDC
- Male connector, M12 x 1, 8-pole
- RS422 with inverted signals
- Pulse frequency max. 300 kHz
- 4096 pulses per revolution

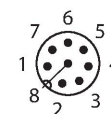
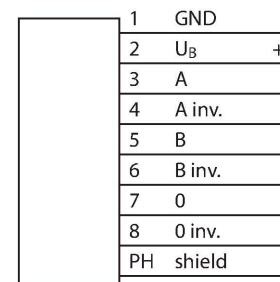

Technical data

Shaft diameter D (mm)	14
Shaft material	Stainless steel
Housing material	Die-cast zinc
Electrical connection	Connector, M12 × 1
	8-pin
Axial shaft load	40 N
Radial shaft load	80 N
Environmental conditions	
Ambient temperature	-40...+85 °C
Vibration resistance (EN 60068-2-6)	300 m/s ² , 10...2000 Hz
Shock resistance (EN 60068-2-27)	3000 m/s ² , 6 ms
Protection class	IP67
Protection class housing	IP65
Protection class shaft	IP65